

TOWN HWY. NO.	LENGTH IN MILES CLASS 3	LENGTH IN MILES CLASS 4	LEGAL TRAIL NO.	LENGTH IN MILES LEGAL TRAIL
4	3.69	(0.07)	63	0.10
6	1.20		64	0.08
7	0.47		65	0.30
8	0.63		66	0.14
10	1.91	(0.42)	67	0.62
10		(0.29)	68	0.36
11	0.67		69	0.16
12	1.71		70	0.21
13	0.24		71	0.28
14	2.70		72	0.33
15	0.13		73	0.28
16	0.65		74	0.06
17	0.70		75	0.38
18	0.65		76	1.01
19	0.19		77	0.45
20	0.30		78	0.39
21	1.40		79	0.18
22	0.27	(0.53)	80	0.52
23	0.90		81	0.14
24	0.65	(0.10)	82	0.43
25	0.53		83	0.31
25		(0.07)	84	0.71
26	2.10		85	0.29
27		(0.55)	86	0.13
28	0.25		87	0.67
29	0.45		88	0.32
30	0.04		89	0.17
31	0.20		90	0.14
32	0.15		91	0.05
33	0.13		92	0.61
34	0.36		93	0.36
35	0.07		94	0.82
36	0.43		95	0.16
37	0.45		96	0.13
38	0.36		97	0.37
39	0.25		98	0.36
40	0.22		99	0.13
41	0.34		100	0.14
42	0.10		101	0.30
43	0.15		102	0.16
44	0.30		103	0.12
45	0.29		104	0.27
46	0.22		105	0.30
47	0.38		106	0.30
48	0.16		107	0.62
49	0.24		108	0.58
50	0.18		109	0.44
51	0.11		110	0.21
52	0.37		111	0.21
53	0.18		112	1.02
54	0.28		113	0.47
55	0.30		114	0.77
56	0.18		115	0.79
57	0.46		116	0.19
58	0.51		117	0.39
59	0.10		118	0.10
60		(0.39)	119	0.50
61	0.12		120	0.12
62	0.66		TOTAL	50.83
			TOTAL	2.42

* This portion of town highway is Class 3, but is functionally Class 4

MILEAGE SUMMARY			
CLASS 2			
TH-1	7.700		
TH-2	1.050		
TH-3	2.100		
TH-4	2.950		
TH-5	3.880		
TH-6	1.600		
TOTAL CLASS 2	19.280		
CLASS 3			
TOTAL CLASS 3	50.830		
TOTAL TOWN	70.110		
STATE HIGHWAY			
VT-2A	5.940		
VT-116	0.417		
TOTAL STATE HIGHWAY	6.357		
US HIGHWAY			
US-2	5.897		
TOTAL US HIGHWAY	5.897		
TOTAL STATE	12.254		
INTERSTATE			
I-89	5.459		
TOTAL INTERSTATE	5.459		
INTERSTATE - Ramp			
I-89	0.929		
TOTAL INTERSTATE - Ramp	0.929		
TOTAL INTERSTATE	6.388		

TOTAL, TRAVELED HIGHWAYS, FEB. 10, 2009: 88.752
(Excludes Class 4 and Legal Trail Mileage)

STRUCTURES - SURFACE WATER NOTE:
STRUCTURES: Town short structures (bridges or culverts from 4-feet to less than 20-feet) are drawn from the Vermont Online Bridge & Culvert Inventory Tool (VOBCIT) database.
NOTE: Town shorts are not consistently tagged within VOBCIT.
The surface waters are from the Vermont Hydrological Dataset (VHD). Only the named streams are shown.

LEGAL TRAIL NO. 1
TOTAL 0.80

DISCLAIMER:
The untraveled highways (laid-out town highways), discontinued highways, and legal trails shown herein are those of which the Agency of Transportation has record; others may exist.
Highway and bridge data by the Agency of Transportation. All other data from the Vermont Center for Geographic Information.

HIGHWAYS

- INTERSTATE OR DIVIDED HIGHWAY
- STATE - HARD SURFACE OR PAVED
- TOWN - HARD SURFACE OR PAVED
- U.S. ROUTE
- STATE ROUTE
- CLASS 1
- CLASS 2
- CLASS 3
- CLASS 4
- LEGAL TRAIL

BRIDGE OR CULVERT

- BRIDGE OR CULVERT GREATER THAN 20'
- BRIDGE OR CULVERT 6' - 20'
- TOWN SHORT STRUCTURE

POLITICAL SUBDIVISIONS

- STATE BOUNDARY
- COUNTY BOUNDARY
- TOWN BOUNDARY
- VILLAGE BOUNDARY
- URBAN COMPACT BOUNDARY
- WATER BODIES
- STREAM OR BROOK

FEDERAL CLASSIFICATION IDENTIFIER

- FAU URBAN ARTERIAL OR COLLECTOR
- MA MINOR ARTERIAL
- MJC MAJOR COLLECTOR
- MNC MINOR COLLECTOR
- PA PRINCIPAL ARTERIAL

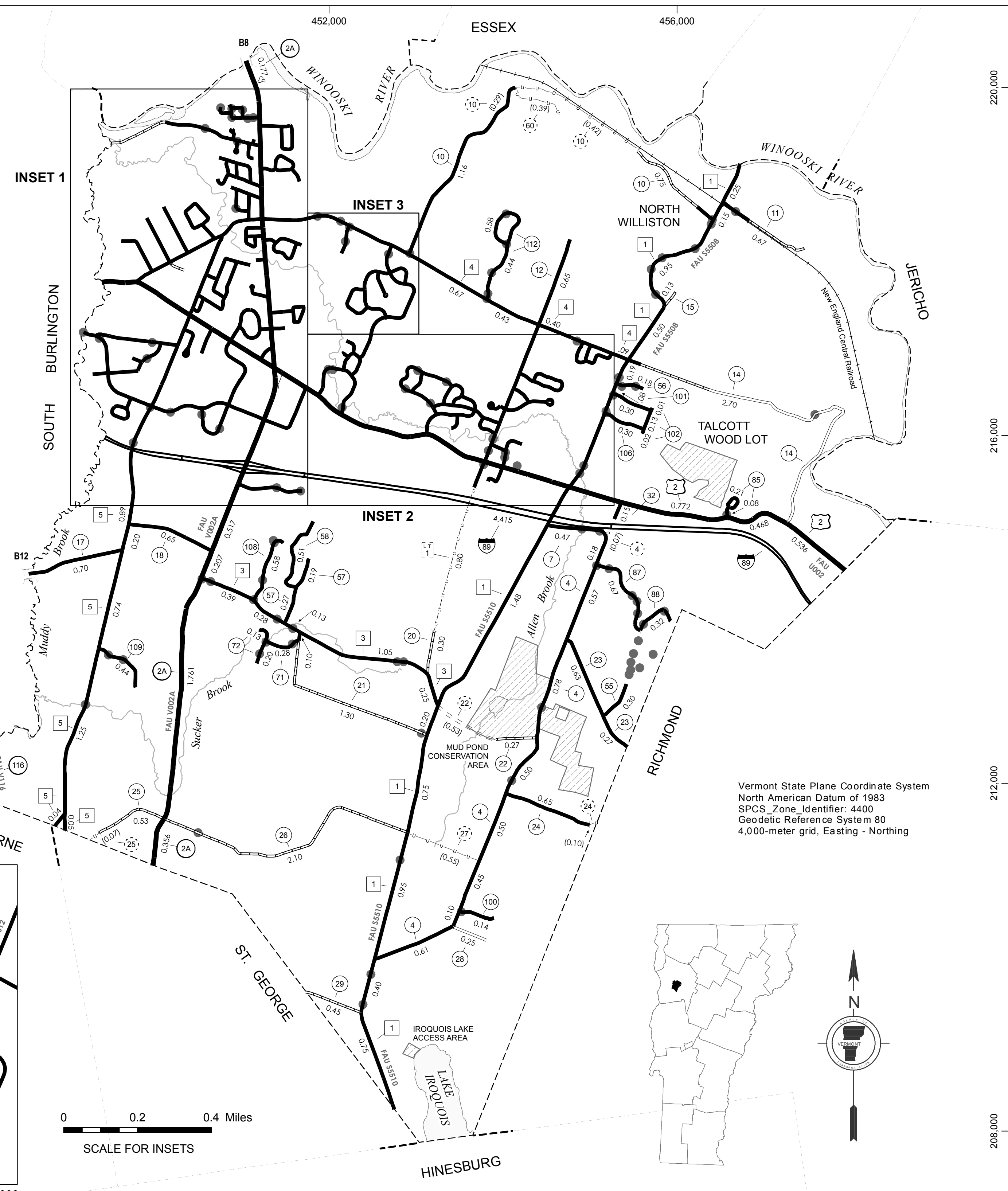
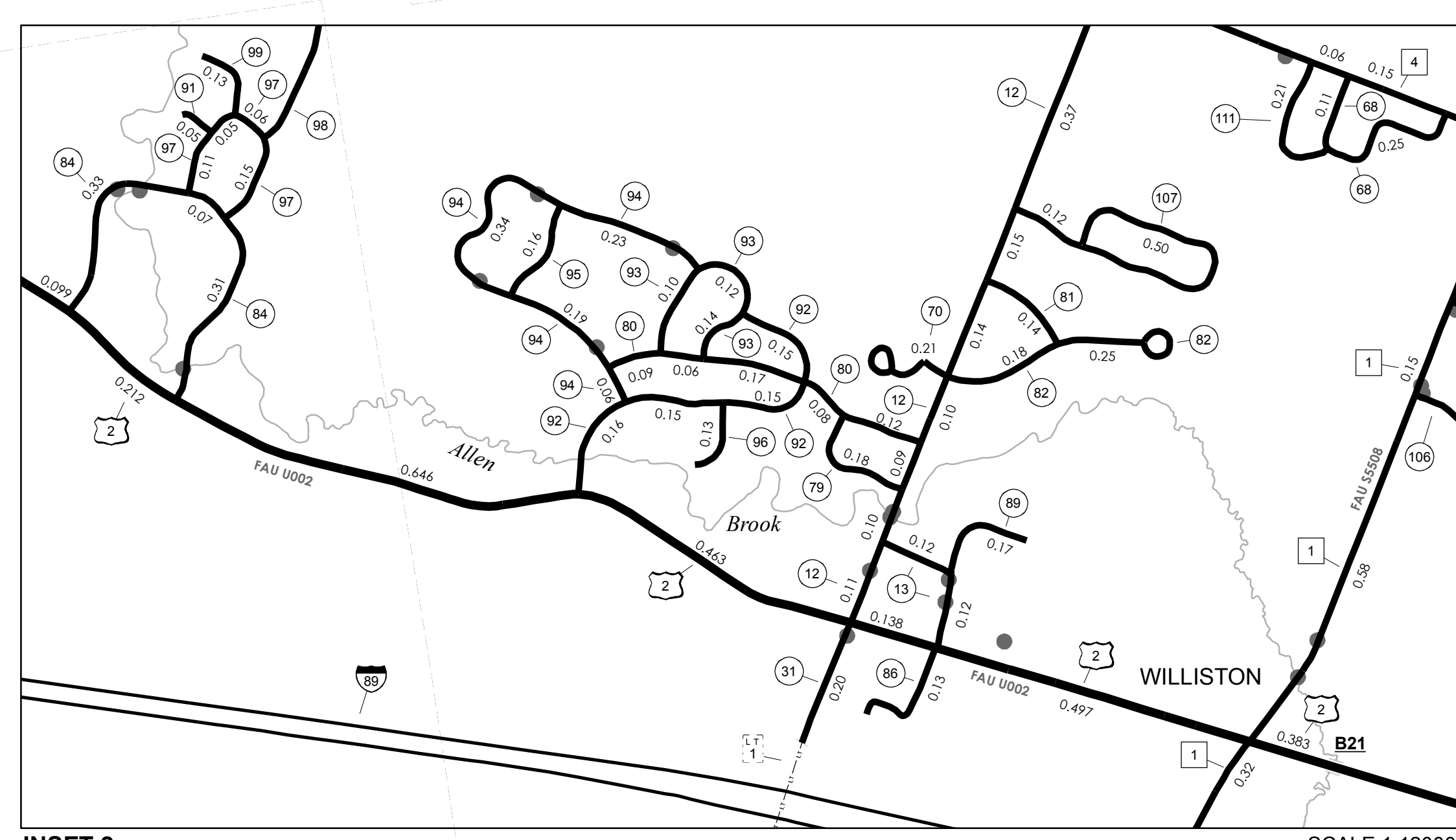
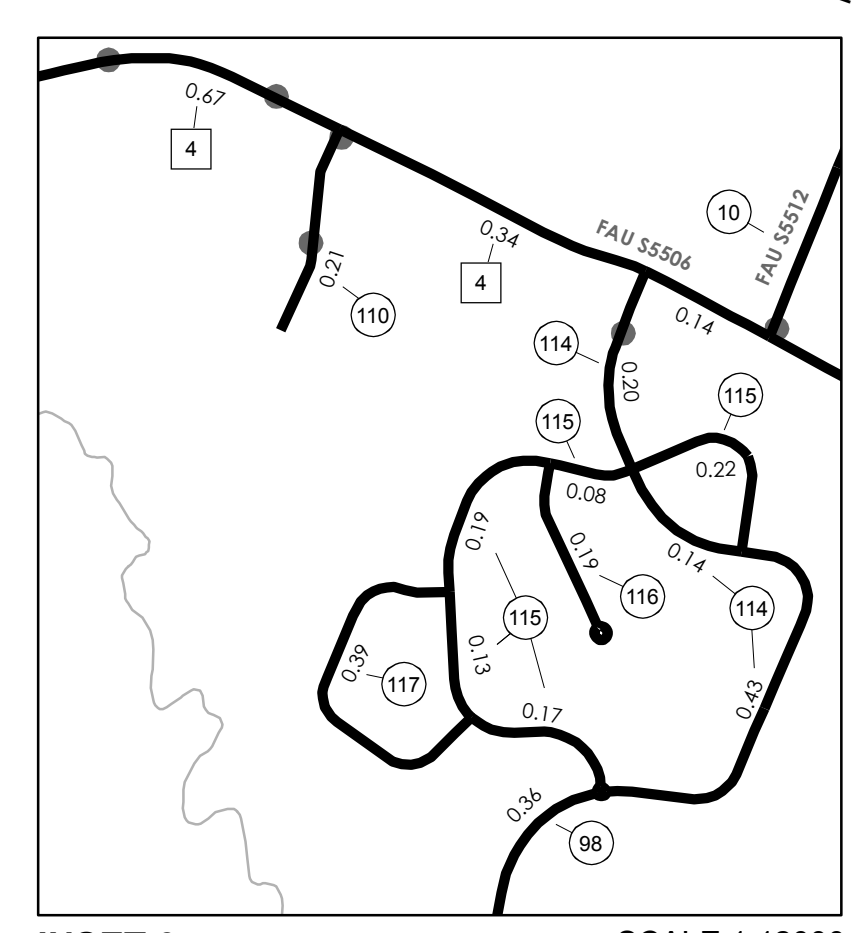
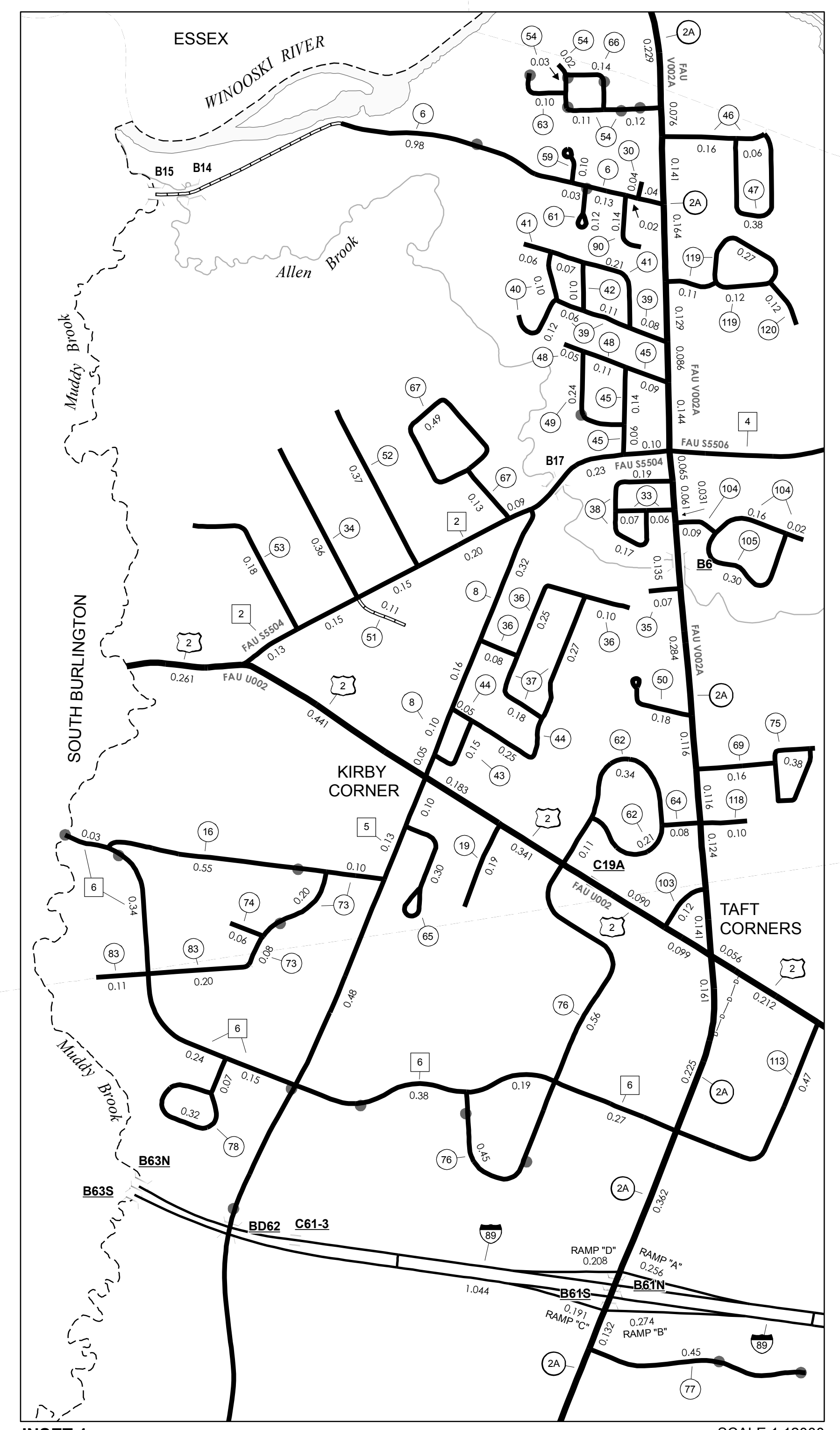

VERMONT GENERAL HIGHWAY MAP
Town of Williston
CHITTENDEN COUNTY
Transportation District #5
Prepared by the Vermont Agency of Transportation Division of Planning, Outreach and Community Affairs in cooperation with U.S. Department of Transportation Federal Highway Administration
Mileage as of February 10, 2009
Map prepared July 9, 2009
SCALE 1:31,680

0.5 0 0.5 1 1.5 2 Miles
1 0 1 2 Kilometers