

TOWN HWY NO.	LENGTH IN MILES CLASS
4	0.000 (0.230)
3	0.000 (0.990)
2	0.000 (0.990)
1	0.000 (0.990)
10	0.000 (0.150)
11	0.000 (0.500)
12	0.000 (0.500)
13	0.000 (0.500)
14	0.000 (0.500)
15	0.000 (0.500)
16	0.000 (0.500)
17	0.000 (0.500)
18	0.000 (0.500)
19	0.000 (0.500)
20	0.000 (0.500)
21	0.000 (0.500)
22	0.000 (0.500)
23	0.000 (0.500)
24	0.000 (0.500)
25	0.000 (0.500)
26	0.000 (0.500)
27	0.000 (0.500)
28	0.000 (0.500)
29	0.000 (0.500)
30	0.000 (0.500)
31	0.000 (0.500)
32	0.000 (0.500)
33	0.000 (0.500)
34	0.000 (0.500)
35	0.000 (0.500)
36	0.000 (0.500)
37	0.000 (0.500)
38	0.000 (0.500)
39	0.000 (0.500)
40	0.000 (0.500)
41	0.000 (0.500)
42	0.000 (0.500)
43	0.000 (0.500)
44	0.000 (0.500)
45	0.000 (0.500)
46	0.000 (0.500)
47	0.000 (0.500)
48	0.000 (0.500)
49	0.000 (0.500)
50	0.000 (0.500)
51	0.000 (0.500)
52	0.000 (0.500)
53	0.000 (0.500)
54	0.000 (0.500)
55	0.000 (0.500)
56	0.000 (0.500)
57	0.000 (0.500)
58	0.000 (0.500)
59	0.000 (0.500)
60	0.000 (0.500)
61	0.000 (0.500)
62	0.000 (0.500)
63	0.000 (0.500)
64	0.000 (0.500)
65	0.000 (0.500)
66	0.000 (0.500)
67	0.000 (0.500)
68	0.000 (0.500)
69	0.000 (0.500)
70	0.000 (0.500)
71	0.000 (0.500)
72	0.000 (0.500)
73	0.000 (0.500)
74	0.000 (0.500)
75	0.000 (0.500)
76	0.000 (0.500)
77	0.000 (0.500)
78	0.000 (0.500)
79	0.000 (0.500)
80	0.000 (0.500)
81	0.000 (0.500)
TOTAL	49.990 21.470

* PORTION(S) OF THESE TOWN HIGHWAYS ARE CLASS 3, BUT ARE FUNCTIONALLY CLASS 4.

MILEAGE SUMMARY	
CLASS 1 TOWN HIGHWAYS:	
TOTAL CLASS 1 TOWN HWYS.	0.000
CLASS 2 TOWN HIGHWAYS:	
TOTAL CLASS 2 TOWN HWYS.	12.180
CLASS 3 TOWN HIGHWAYS:	
TOTAL CLASS 3 TOWN HWYS.	49.990
TOTAL TOWN HWYS.	62.170
STATE HIGHWAYS:	
INTERSTATE RAMPS	0.000
TOTAL INTERSTATE HWYS.	0.000
STATE HWY. 25	6.438
STATE HWY. 302	3.397
TOTAL NON-INTERSTATE HWYS.	9.835
TOTAL STATE HWYS.	9.835
TOTAL TRAVELLED HWYS., FEB. 10, 2003	72.005
(EXCLUDES CLASS 4 MILEAGE)	

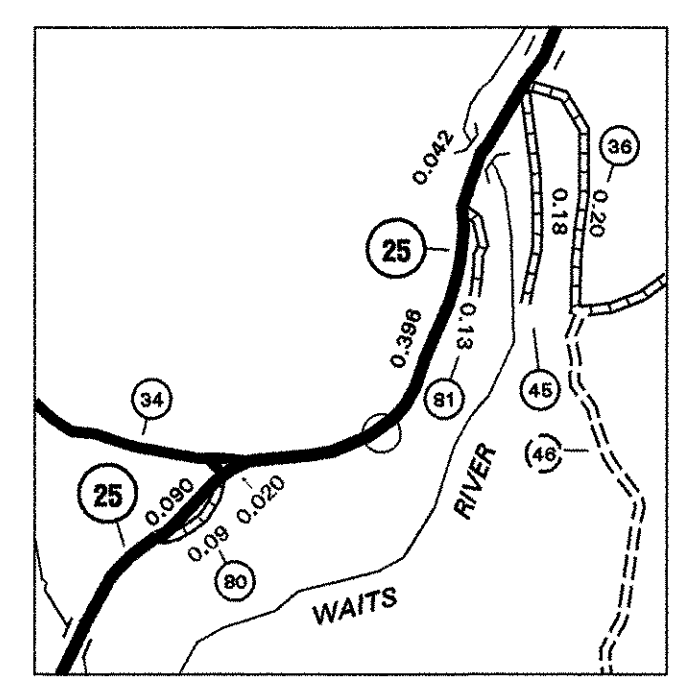

WEST TOPSHAM INSET 1

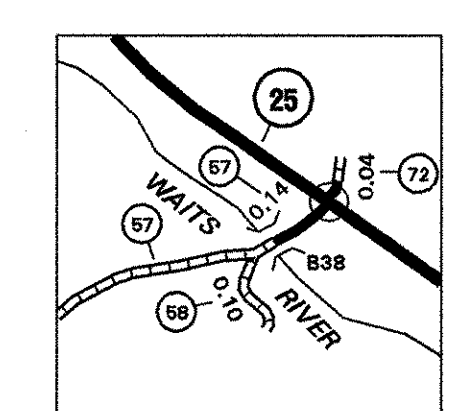

WAITS RIVER INSET 3

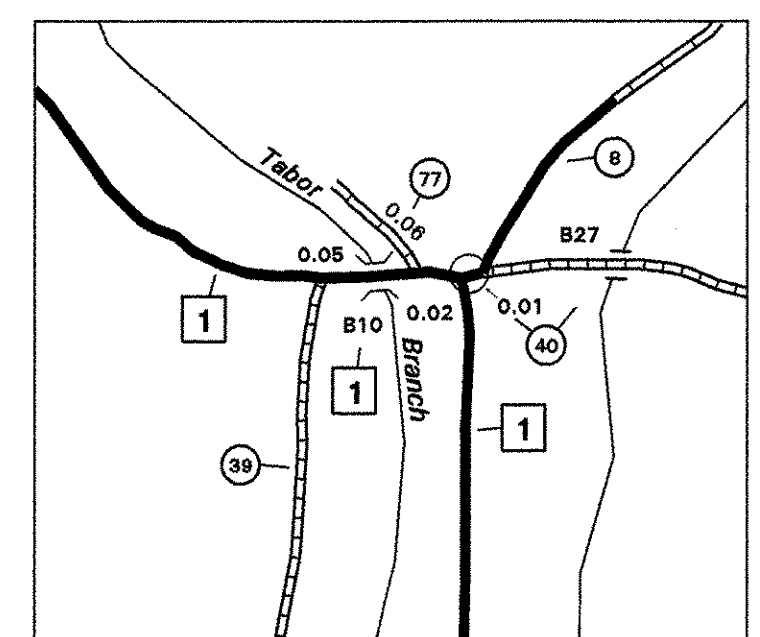

EAST TOPSHAM INSET 2

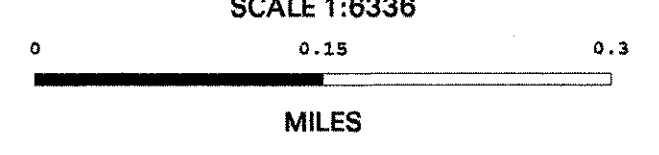

DISCLAIMER:
Highway and bridge data by Vermont Agency of Transportation, Division of Technical Services. All other data from Vermont Center for Geographic Information.

HIGHWAYS

- INTERSTATE
- STATE HIGHWAY SYSTEM
- TOWN HIGHWAY SYSTEM
- IMPASSABLE OR UNTRAVELED
- DISCONTINUED
- LEGAL TRAIL
- FOOT TRAIL

ROAD SURFACE TYPES

- STATE PAVED
- OTHER PAVED
- STATE GRAVEL
- OTHER GRAVEL
- GRADED AND DRAINED
- UNIMPROVED/PRIMITIVE

POLITICAL SUBDIVISIONS

- STATE BOUNDARY
- COUNTY BOUNDARY
- TOWN BOUNDARY
- CITY BOUNDARY
- VILLAGE BOUNDARY
- URBAN COMPACT BOUNDARY

NATURAL FEATURES

- SINGLE LINE STREAM
- OPEN WATER
- SWAMP

MISCELLANEOUS

- DAM

OTHER TRANSPORTATION

- RAILROAD
- AIRPORT TERMINAL

Legend for Highway Markers:

- 89: INTERSTATE ROUTE
- 2: U.S. NUMBERED ROUTE
- 3: STATE NUMBERED ROUTE
- 7: INTERCHANGE NUMBER
- 4: CLASS 1 TOWN HIGHWAY
- 2: CLASS 2 TOWN HIGHWAY
- 3: CLASS 3 TOWN HIGHWAY
- 5: CLASS 4 TOWN HIGHWAY
- NFR: NATIONAL FOREST ROAD
- SFH: STATE FOREST HIGHWAY

Legend for Bridge/Culvert Markers:

- BRIDGE OR CULVERT < 6'
- BRIDGE OR CULVERT 6' - 20'
- BRIDGE GREATER THAN 20'
- CB: COVERED BRIDGE

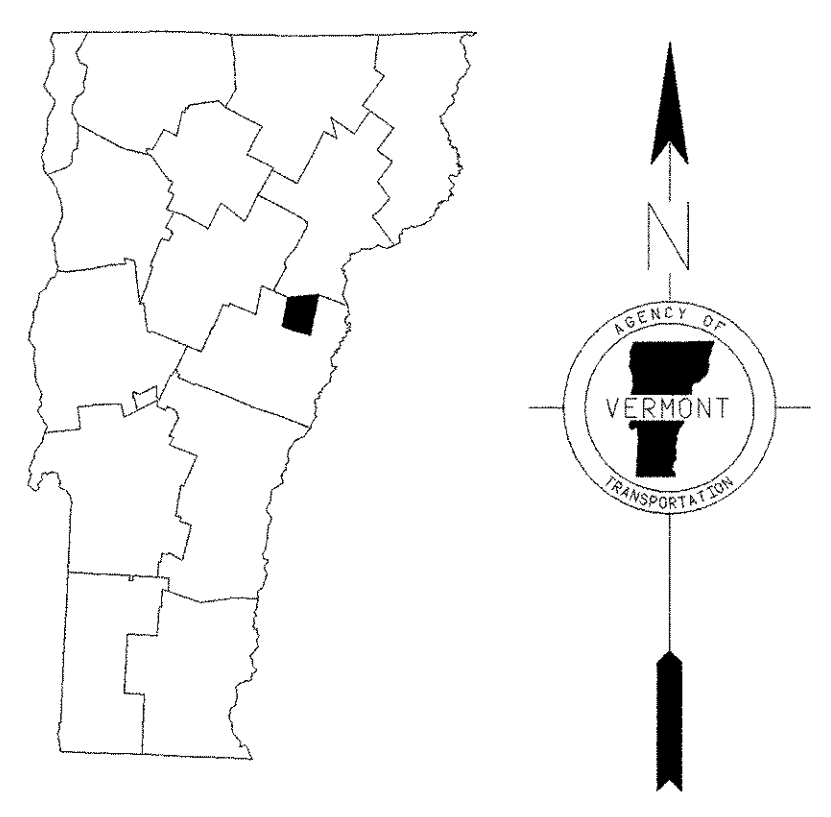

VERMONT GENERAL HIGHWAY MAP TOWN OF TOPSHAM

PREPARED BY THE
VERMONT AGENCY OF TRANSPORTATION
PROGRAM DEVELOPMENT DIVISION
IN COOPERATION WITH
U.S. DEPARTMENT OF TRANSPORTATION
FEDERAL HIGHWAY ADMINISTRATION

